



FOOTPATH UPGRADE
as agreed per permission 18/37820
@ RFI stage
currently under construction

pedestrian
crossing

STOP

EX.L
12.60

EX.L
13.21



T.O.W
14.97

A map showing the proposed footpath route through the park. The route is marked with a double line and labeled "proposed footpath". The map includes various green areas representing grass and trees, and a brown area representing a path or road. The route starts near the bottom left and goes towards the top right.

Fence

EX.R.
11.25

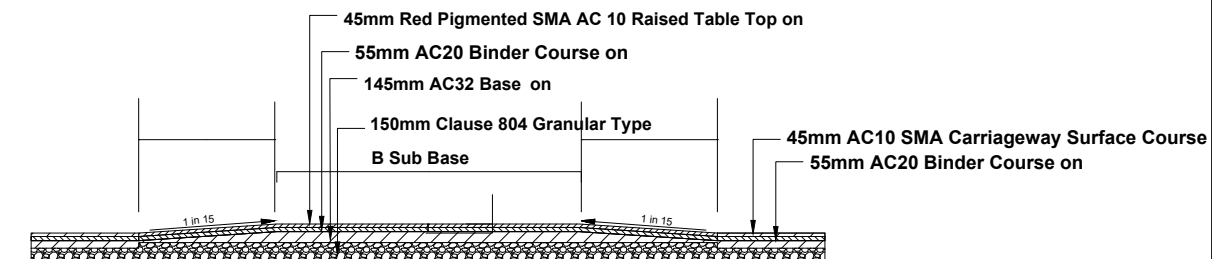
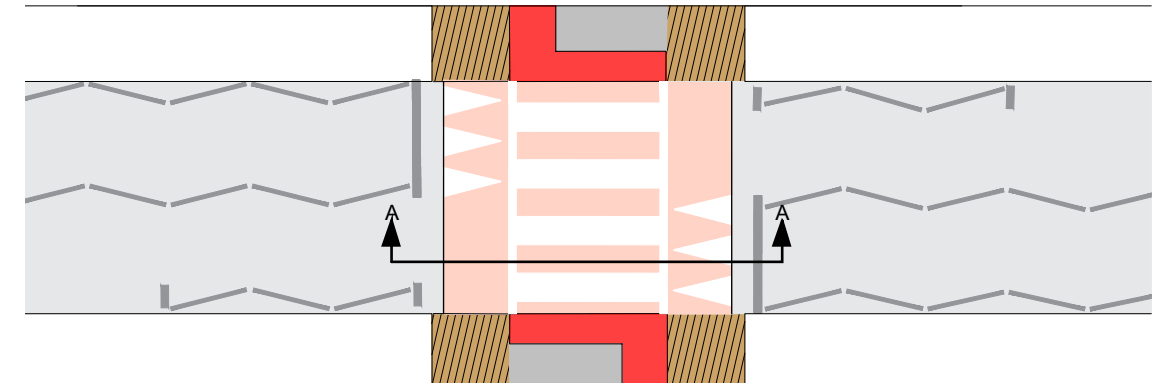
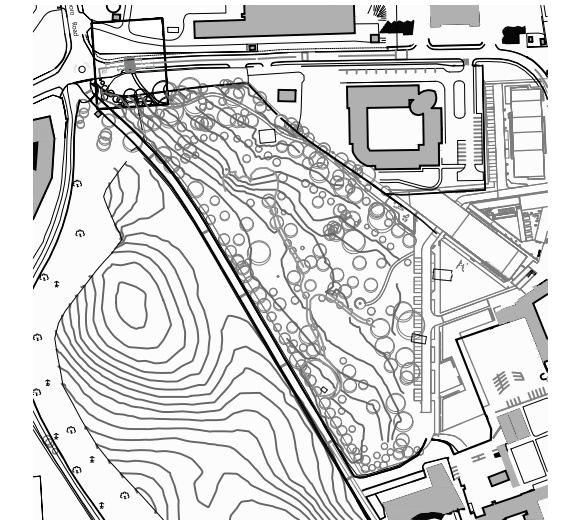

MHL & Associates Ltd.
Consulting Engineers

03.2022 PEDESTRIAN CROSSING SHIPSEYBARRY
place makers

PROJECT :	PHASE 2- THE FARM - BESSBOROUGH	DRAWING DESCRIPTION:	PEDESTRIAN CROSSING	CLIENT :	ESTUARY VIEW ENTERPRISES LTD
SCALE :	1:100 & 1:200 @ A3	DATE :	JANUARY 2022	OVERSEEN BY :	JJ
			APPROVED BY :	GB	DRAWING NO. :
					SB-2020-107-901